

# Mounting solutions

proven, reliable, durable

# WaterVision

MORE LIGHT LESS WORRY



***“Reliable, efficient and simple solutions for the installation of underwater lighting”***

## New construction

Do you wish:

- 100% flush installation?
- A movable floor?
- An “invisible” or just visible luminaire?
- Vandalism proof?
- Fast and efficient installation?
- Simplicity and transparency?

Click here for the solution for your construction form:

- ② [Tile pools of waterproof concrete](#)
- ② [Tile pools of concrete with a waterproof finish](#)
- ② [Liner / foil pools](#)
- ② [Preformed pools \(prefab\)](#)
- ② [Stainless steel pools](#)

## Replacement

- ② [Halogen lighting](#)
- ② [Wibre, Hugo Lahme, BEGA, Astral or MTS LED lighting](#)

WaterVision has standard adapter sets for almost all common brands. The flat design of the WV15 underwater floodlights fits on / over any recessed housing.

## Renovation

- ② [Construction on the pool wall without a recessed housing](#)

- Since 2004
- Reliable
- Proven quality
- 100% flat
- Efficient
- Fits on every housing
- Directly on the wall
- Robust
- Sustainable
- All type of pools
- New constructions and renovations
- Made in Holland

### Three different LED fixtures

In addition to the various installation options, WaterVision offers three variants of LED fixtures that can be used for different purposes. Think, for example, of a movable floor, whether or not a recessed housing is present or purely for the appearance. The following three WV15 luminaires are available:

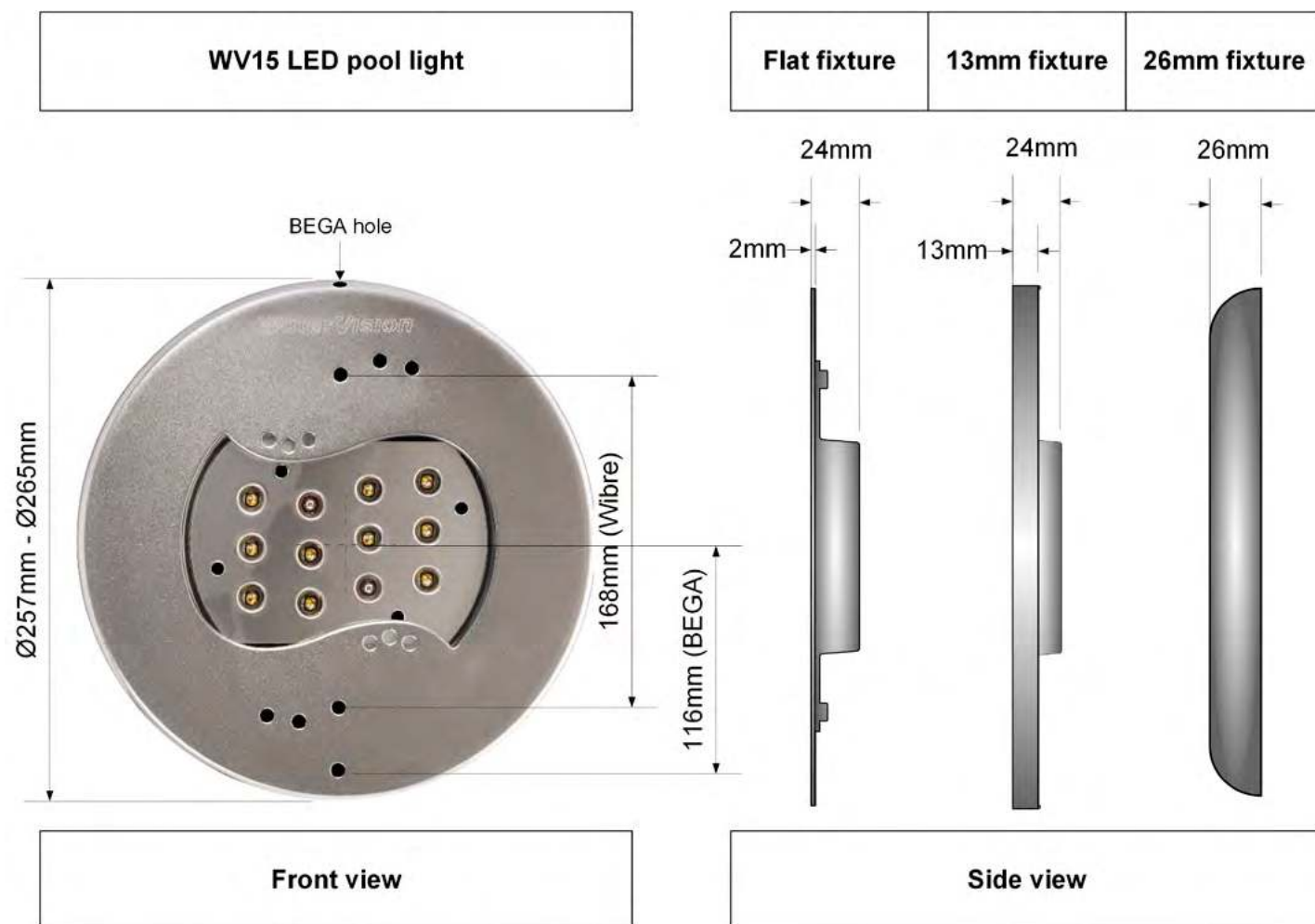

### The hole pattern

The hole pattern looks charming and has an important function, which is to mount the lighting on recessed housings from Wibre, BEGA, Lahme, MTS, Astral and PAR56 lights:

- The 168mm pitch corresponds to the size of Wibre lighting
- The bottom hole and the top hole for BEGA lighting
- The pitch can be varied with the other holes



WaterVision offers complete adapter sets for specific MTS, Lahme and Astral, as well as universal adapter sets.

## New construction

For tile pools, flush installation offers the following advantages:

1. The fixtures are “invisible” in the wall
2. 100% flat is ideal for movable floors
3. Housing and flange are made from one piece of stainless steel and are therefore 100% waterproof
4. Vandal proof. Can not be pulled off easily
5. Ideal for mounting in rapids
6. Sustainable solution



Part nr.	Description	Image
V0106 (chlorine) V0132 (salt)	Recessed housing (316L or 904L), for concrete pools and concrete pools with composite sealing for chlorinated water and salt water, Ø338mm x 45mm with 55mm flange. The recessed housing is: - Very robust (made of 316L or 904L stainless steel) - Only 45 mm deep - Ideal for public and private pools	
V0052	Plastic mounting ring for flush mounting (Ø278x24mm). This ring is placed between the tiles and provide a complete flush mounting of the lamp. This mounting ring is optimally used in combination with the 13mm fixture.	

## Installation diagram

The installation diagram below shows how the WV15 LED underwater floodlight with 13mm fixture is mounted on the recessed housing in combination with the mounting ring in the pool wall.

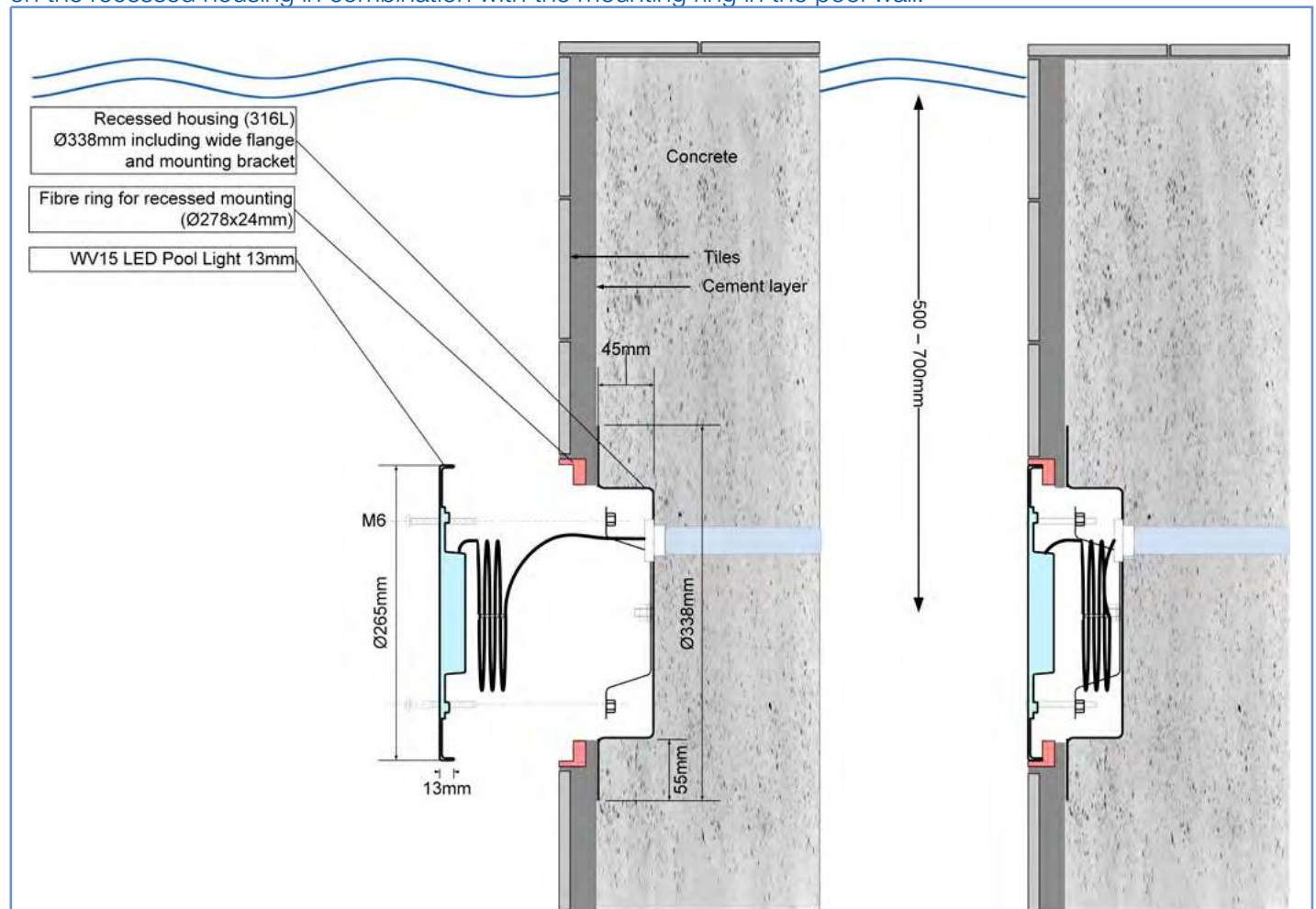

### Replacement for Wibre, Hugo Lahme, BEGA, Astral or MTS LED lighting

WaterVision offers various options for renovation of a swimming pool in which old lighting must be replaced by new lighting. In almost all cases, the WaterVision lighting fits on the existing recessed housings. The hole of the recessed housing is completely covered by the lamp. Depending on the brand of recessed housing, we recommend the 2mm, 13mm or 26mm fixture. WaterVision has standard adapter sets for almost all common brands. [Here you can find the installation instruction per brand.](#)



### Installation diagram

The installation diagram below shows an example of how a WV15 LED underwater floodlight with 13mm fixture is mounted on any brand of recessed housing in the pool wall.

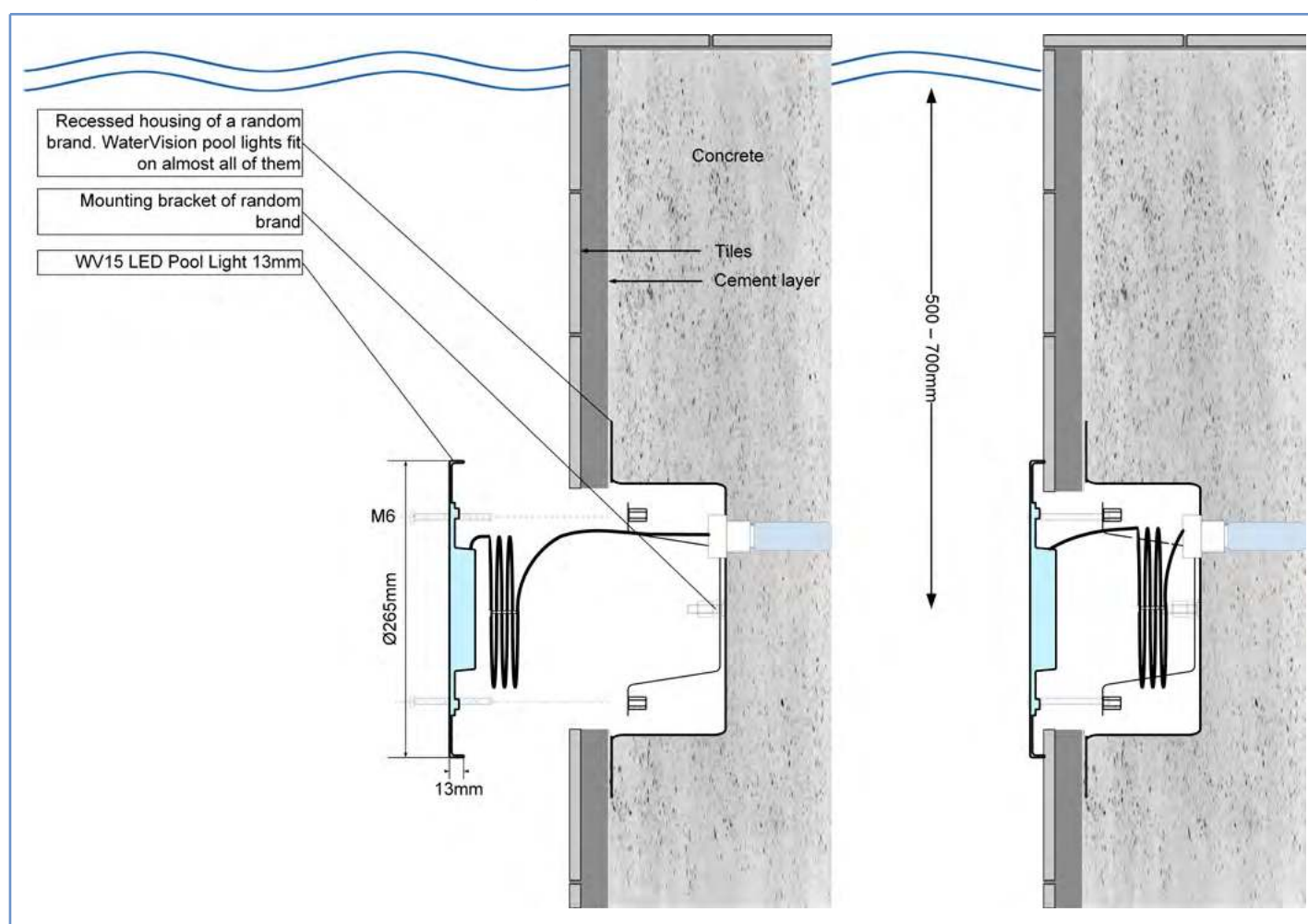



## Renovation of existing pool without existing lighting

The 26mm fixture fits on any flat wall. An 8mm hole is drilled for the cable entry. The seal on the outer side is provided by an industrial cable plug.

Advantages:

- Minimal chopping and breaking work
- Quick to assemble
- Simple and therefore a low cost solution

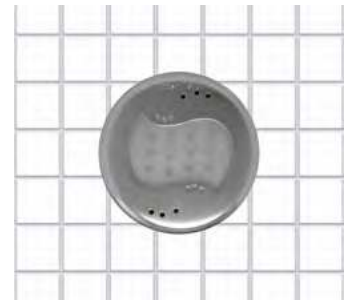

Part nr.	Description	Image
V0021	Rubber cable wall lead-through (red, Ø25x50mm)	

## Installation diagram

The installation diagram below shows how the WV15 LED underwater floodlight with 26mm fixture is mounted on the pool wall without a recessed housing.

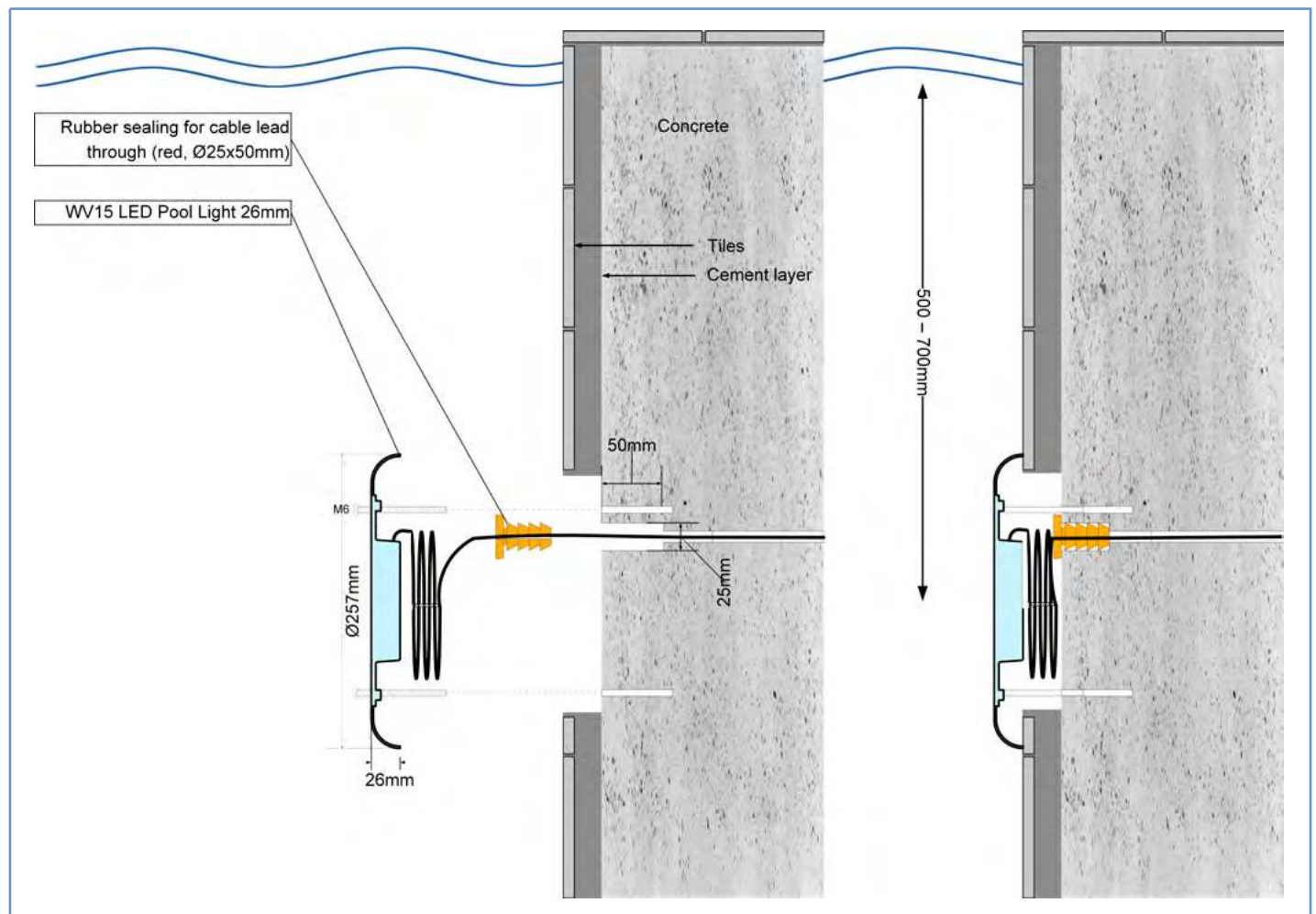

## New construction

For tile pools, flush installation offers the following advantages:

1. The fixtures are “invisible” in the wall
2. 100% flat is ideal for movable floors
3. Housing and flange are made from one piece of stainless steel and are therefore 100% waterproof
4. Vandal proof. Can not be pulled off easily
5. Ideal for mounting in rapids
6. Sustainable solution



Part nr.	Description	Image
V0106 (chlorine) V0132 (salt)	Recessed housing (316L or 904L), for concrete pools and concrete pools with composite sealing for chlorinated water and salt water, Ø338mm x 45mm with 55mm flange. The recessed housing is: - Very robust (made of 316L or 904L stainless steel) - Only 45 mm deep - Ideal for public and private pools	
V0052	Plastic mounting ring for flush mounting (Ø278x24mm). This ring is placed between the tiles and provide a complete flush mounting of the lamp. This mounting ring is optimally used in combination with the 13mm fixture.	

## Installation diagram

The installation diagram below shows how the WV15 LED underwater floodlight with 13mm fixture is mounted on the recessed housing in combination with the mounting ring in the pool wall.

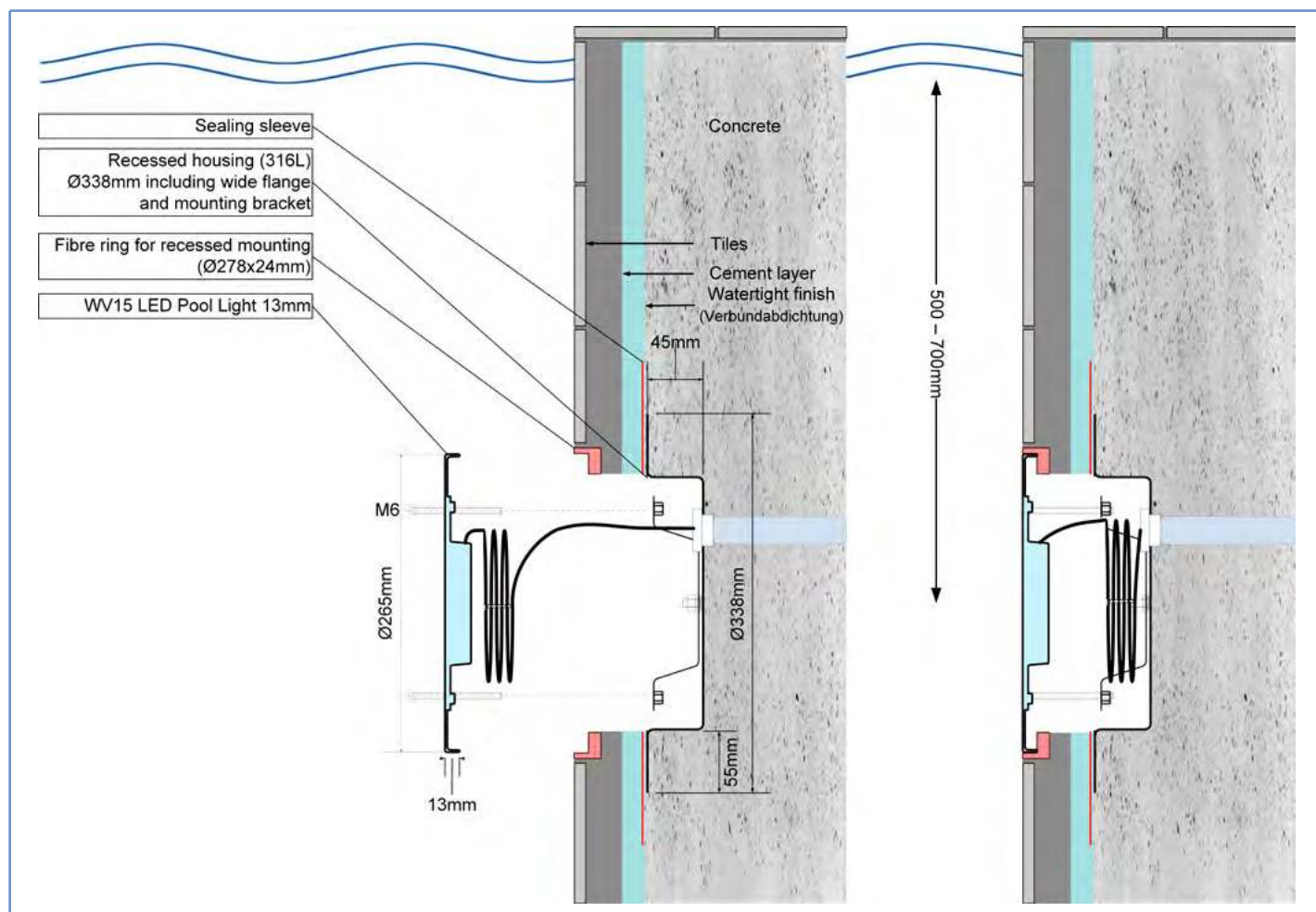

# Liner / foil & prefab pools

easy mounting

# WaterVision

MORE LIGHT LESS WORRY

## New construction and renovation

WaterVision has developed a special recessed housing, flange and sealing rubbers for liner / foil and prefabricated pools. The recessed housing is easily mounted and closed with a sealing rubber. This recessed housing is best to use in combination with the 13mm fixture. The lighting is fixed on the flange, so that it is anchored durable.



Part nr.	Description	Image
WV0168	<p>Recessed housing of stainless steel 316L for chlorine water for WV15 underwater floodlight for liner or prefab pools (Ø254mm x 50mm excluding rubber seal)</p> <p>De recessed housing is:</p> <ul style="list-style-type: none"><li>- Very robust (made of 316L stainless steel)</li><li>- Only 50mm deep</li><li>- Specially developed for liner / foil and prefab pools</li></ul>	

## Installation diagram

The installation diagram below shows how the WV15 LED underwater floodlight with 13mm fixture is mounted in combination with the recessed housing in the pool wall.

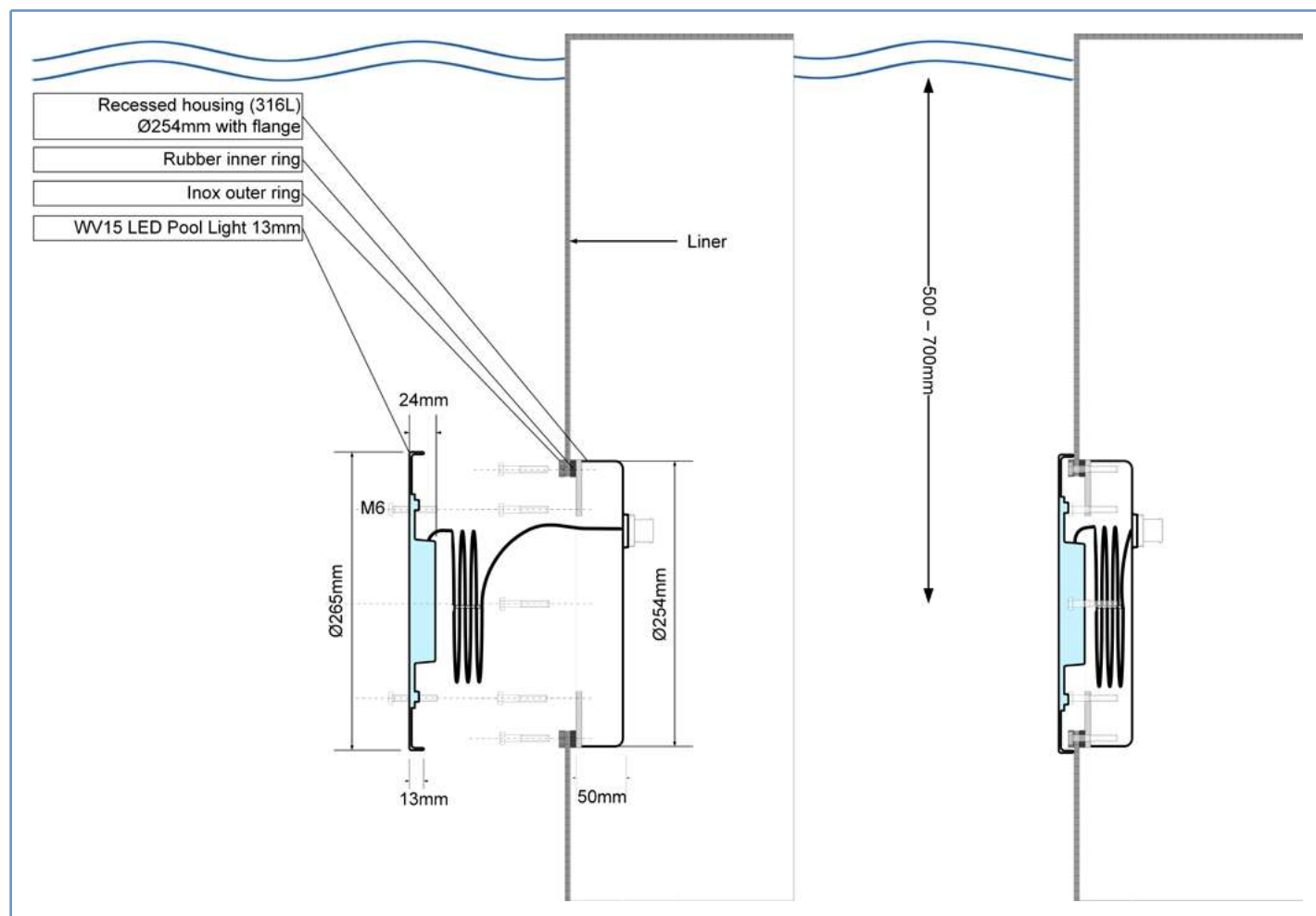

## New construction and renovation

Depending on the options, the stainless steel pools are welded to the pool from the front or rear. For example, when there is not enough space to weld at the back, welding is done at the front. If there is enough space for welding at the back, there is no weld seam in the pool and the lighting can be mounted flat. Here you can use the 2mm fixture, while in the other case you can use the 13mm or the 26mm variant.



Part nr.	Description	Image
V0059	<p>Recessed housing (316L) for and stainless steel pools, Ø250mm x 45mm with 12mm flange.</p> <p>The recessed housing is:</p> <ul style="list-style-type: none"> <li>- Very robust (made of 316L or 904L stainless steel)</li> <li>- Only 45mm deep</li> <li>- Specially developed for stainless steel pools</li> </ul>	

## Installation diagram (Weld seam at the back)

The installation diagram below shows how the WV15 LED underwater floodlight with 2mm (flat) fixture is mounted on the recessed housing in the pool wall when the weld is on the back of the pool wall.

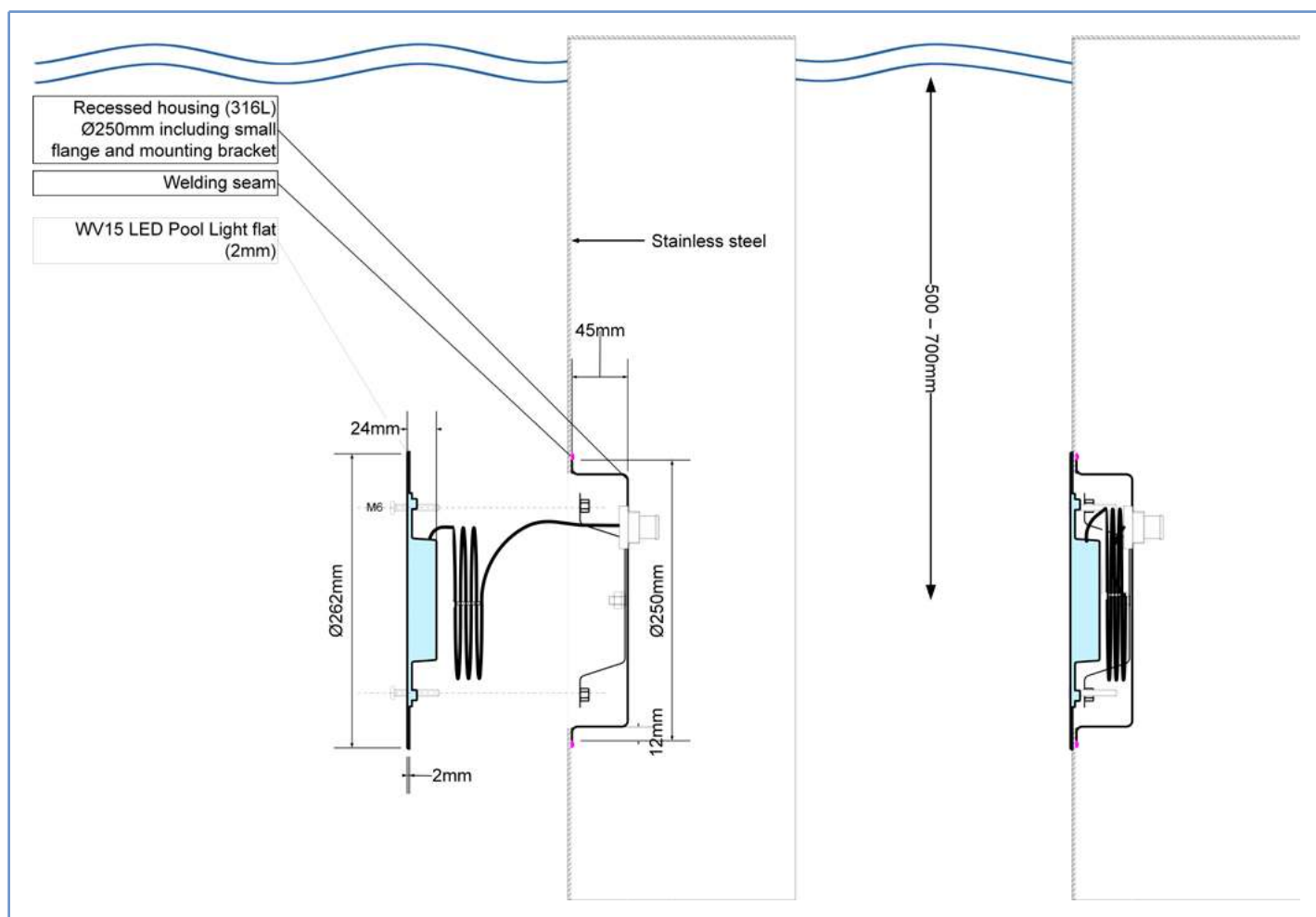

On the next page you can find the installation diagram in case the weld is in the pool (at the front).



# Stainless steel pools

Mounting solutions

# WaterVision

MORE LIGHT LESS WORRY

## Installation diagram (weld seam at the front)

The installation diagram below shows how the WV15 LED underwater floodlight with 13mm fixture is mounted on the recessed housing in the pool wall, when the weld is on the front of the pool wall. In this way, the luminaire falls nicely over the weld seam and is not visible.

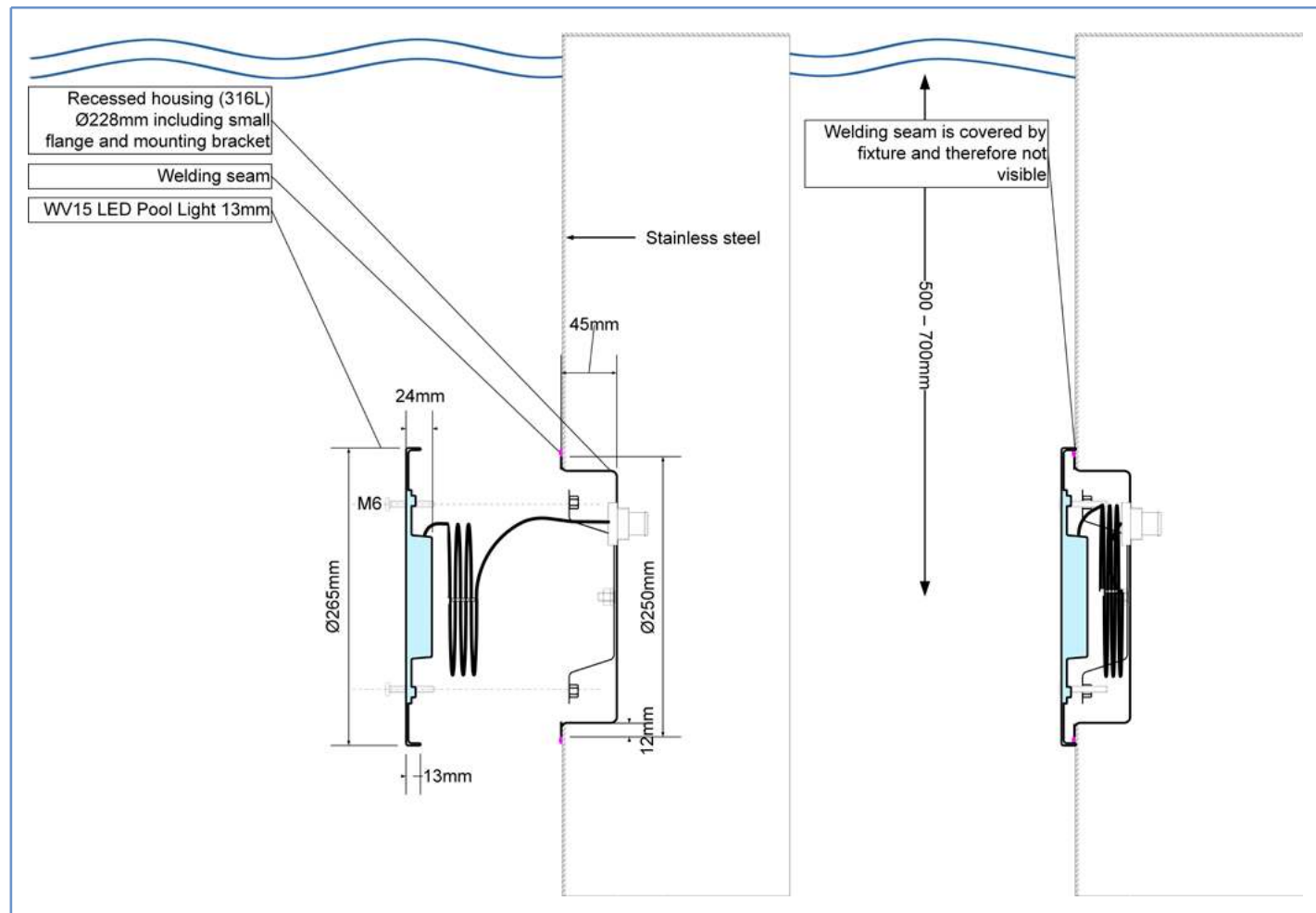

There is a suitable solution for every situation. Do you still have questions after reading this brochure? Please do not hesitate to contact us. Our contact details are on the back.



**WaterVision**  
*MORE LIGHT LESS WORRY*

#### **The Netherlands**

WaterVision BV  
Vlierberg 9  
3755 BS Eemnes  
I. [www.watervision.nl](http://www.watervision.nl)  
E. [info@watervision.nl](mailto:info@watervision.nl)  
T. +31 (0)35-5387959  
F. +31 (0)35-5330551

#### **France**

WaterVision SARL  
130 Boulevard de la Liberté  
FR-59000 Lille  
I. [www.watervision.fr](http://www.watervision.fr)  
E. [info@watervision.fr](mailto:info@watervision.fr)  
T. +33 (0)3 20 57 25 44  
F. +33 (0)3 20 54 03 24

#### **Germany**

WaterVision GmbH  
Boschstraße 16  
D-47533 Kleve  
I. [www.watervision.de](http://www.watervision.de)  
E. [info@watervision.de](mailto:info@watervision.de)  
T. +49 (0)2821 8944850  
F. +49 (0)2821 8944859