

# Installation manual

Fibre ring (V0191) in tiled pools

WV15 flat (for the tiler)

# WaterVision

MORE LIGHT LESS WORRY

The tiler can treat the mounting ring in the same way as tiles. The tile adhesive and cement used for tiles can also be used for the mounting ring

## Place mounting ring step-by-step plan



1. The pot is cast into the concrete of the pool wall.



2. Tile partially over the recessed housing.



3. Place the ring on the recessed housing and screw it to recessed housing.



4. Mark the mounting ring with a marker.



5. Remove the ring from the wall so that only the outline of the ring is visible.



6. Remove the tiles, grind the tiles to the desired shape and stick them back.



7. Fill the edge with cement/tile adhesive and screw the ring back onto the recessed housing so that it is flush with the surface of the tiles. The ring can then be added flush with the other tiles.



8. The installer can then install the pool light.

End result: a 100% flat lamp

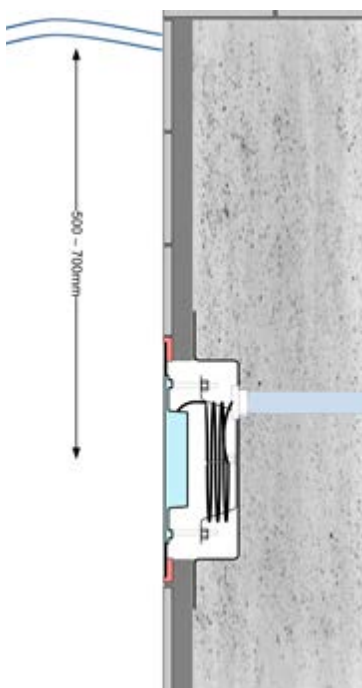
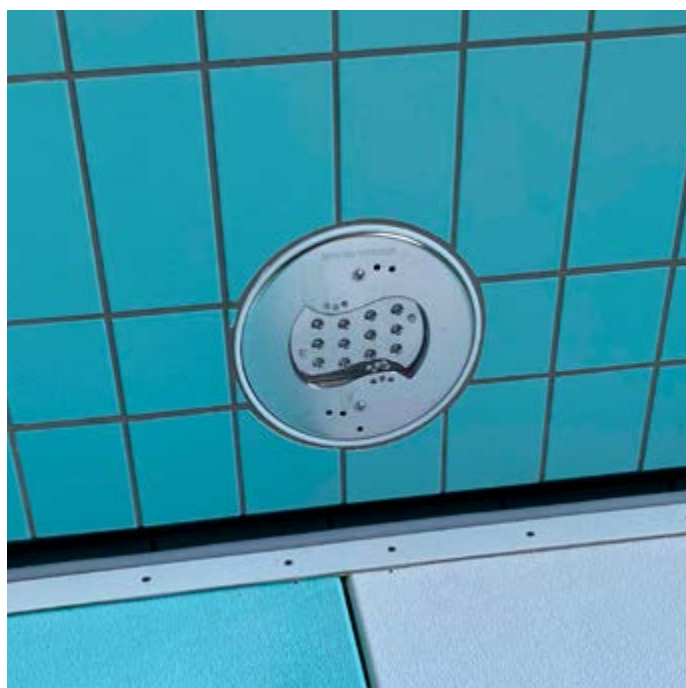

# Installation manual

Fibre ring (V0191) in tiled pools

WV15 flat (for the tiler)

# WaterVision

MORE LIGHT LESS WORRY

Step-by-step plan for placing an underwater floodlight



1. Loosen the screws of the mounting ring

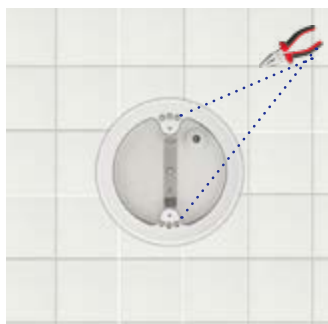

2. Cut off the plastic edge of the mounting ring.



3. This is what the ring looks like after the plastic has been removed.



4. Place the pool light and tighten the screws.

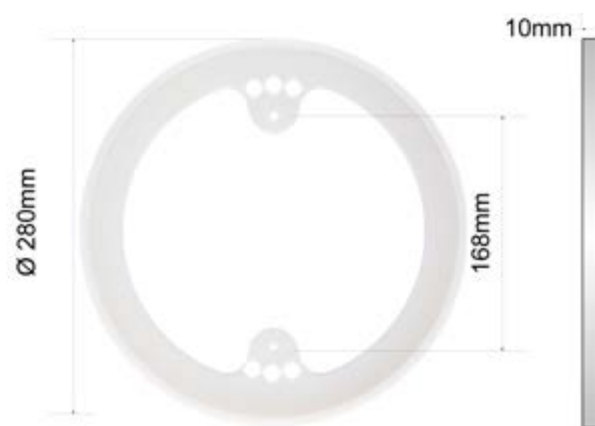

End result: a 100% flat lamp

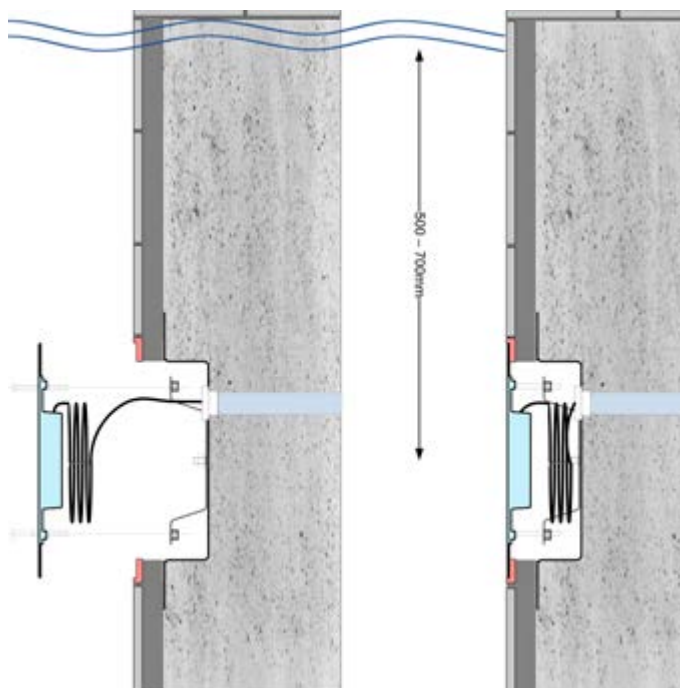
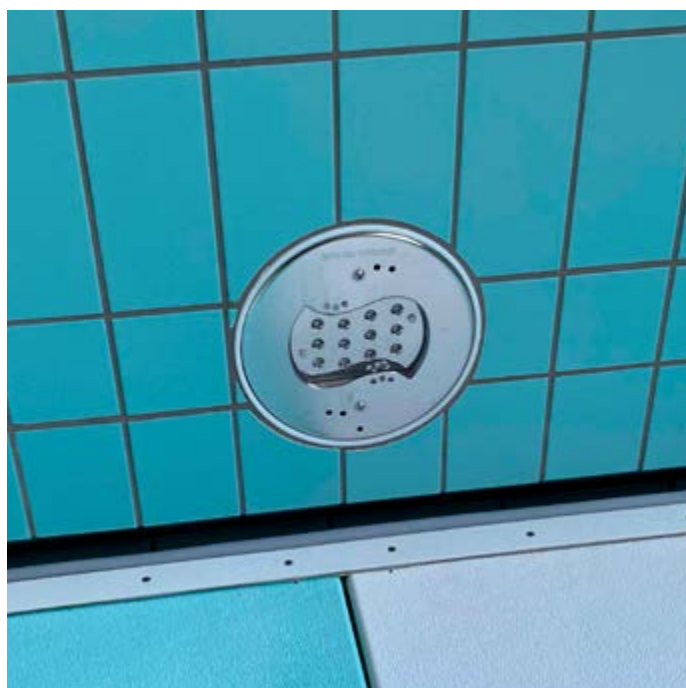



## **The Netherlands**

WaterVision BV  
Vlierberg 9  
NL-3755 BS Eemnes  
I. [www.watervision.nl](http://www.watervision.nl)  
E. [info@watervision.nl](mailto:info@watervision.nl)  
T. +31 (0)35 5387959  
F. +31 (0)35 5330551

## **France**

WaterVision SARL  
130 Boulevard de la Liberté  
FR-59000 Lille  
I. [www.watervision.fr](http://www.watervision.fr)  
E. [info@watervision.fr](mailto:info@watervision.fr)  
T. +33 (0)3 20572544  
F. +33 (0)3 20540324

## **Germany**

WaterVision GmbH  
Boschstraße 16  
D-47533 Kleve  
I. [www.watervision.de](http://www.watervision.de)  
E. [info@watervision.de](mailto:info@watervision.de)  
T. +49 (0)2821 8944850  
F. +49 (0)2821 8944859